

Depending on the model and size, various sizes and types of skids are available for the vCam range.



Standard Skid



Guide Skid



Clip together Skid



Spring Skid

Standard Skids, screw in setscrews, D18 series, D26-MX, D34 and D46 series

The standard skids ship installed on the camera head.

Tools Needed: 3mm / 1/8-inch flat screwdriver.

1. Use the screwdriver to back out the three screws so the camera head will slide unobstructed into the skid.



2. Slide the camera head into the skid until the head is flush with the front.



3. Use the screwdriver to secure the standard skid to the camera head.

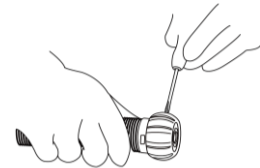

NOTE

Do not overtighten the screws. This may result in stripping the screw threads or damaging the camera housing.



TIP

Apply a layer of electrical tape over the screw holes on the installed skid. This will help keep debris from filling the screw slot, making removing them easier.

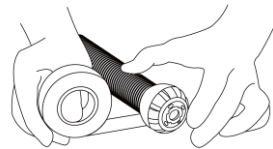
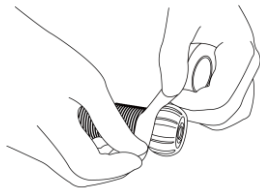

Standard Skids, Two-part clip together, D20-HD, D26-HDR

Tools Needed: No tools are needed

1. Press in on the locking tabs while pulling the two parts apart.



2. Remove the camera from the spring and slide the rear of the skid onto the spring with the tabs facing forward.

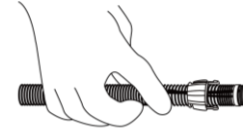

3. Install the camera head onto the spring. Ensure that the camera head is installed correctly by using the camera tools and tightening it until the O-ring is no longer visible.

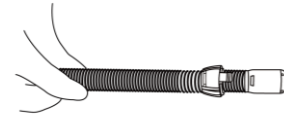

4. Slide the front of the skid over the camera head, aligning the locking tabs with the receptacles.

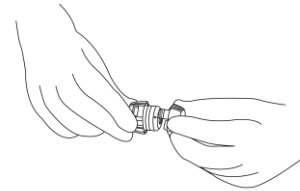

5. Press the two-skid halves together until the tabs lock into the receptacles.

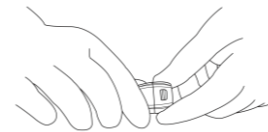

TIP

Wrap approximately two turns of electrical tape over the mounting tabs. This will prevent the cavity from filling with dirt.

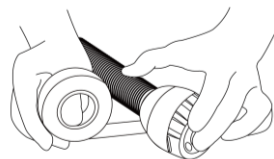
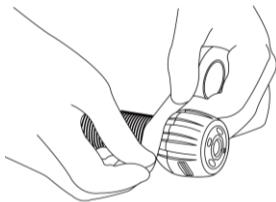

Spring Skid, Clamp around camera spring D18-HD, D20-HD on vCamDrain Spring

Tools Needed: No tools are needed

1. Press the locking tab to open the spring skid.
2. Present the open skid to the spring.
3. Close the skid and press until the locking tab clicks and locks into the mating part.

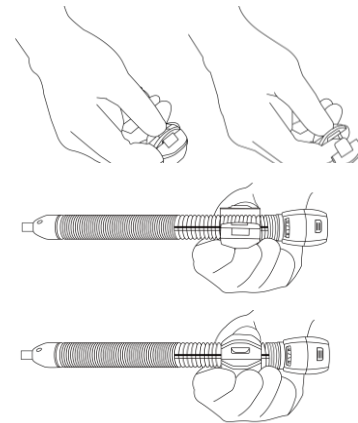

Guide Skids, Clamp around the camera head D18 series, D26-MX, D34 series and D46 series

Tools Needed: 5mm Hex wrench.

1. Use a hex key and loosen the screws so the skid will slide unobstructed onto the camera head.
2. Slide the camera head into the skid until the head is flush with the front.
3. Use a hex key to secure the skid to the camera head.
4. Check that the skid is secure by turning and pulling it simultaneously.

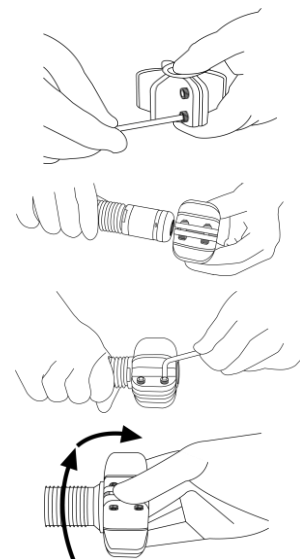

NOTE

Refrain from attempting to close the guide skid fins together completely. Doing so can result in damage to the camera head or the skid.

